

200 Seats ( 20 x 5' dim. table, 10 chairs per)

Sample Seating Plan

Reading Room:  
 Capacities ( max. ) : Dinner -200, Reception- 275, Theater Style-250  
 Approx. 2800 sf available space in main reading room  
 Flooring: Carpet  
 Underbalcony ceiling clearance : +18'-1"  
 High ceiling clearance: +38'-4"

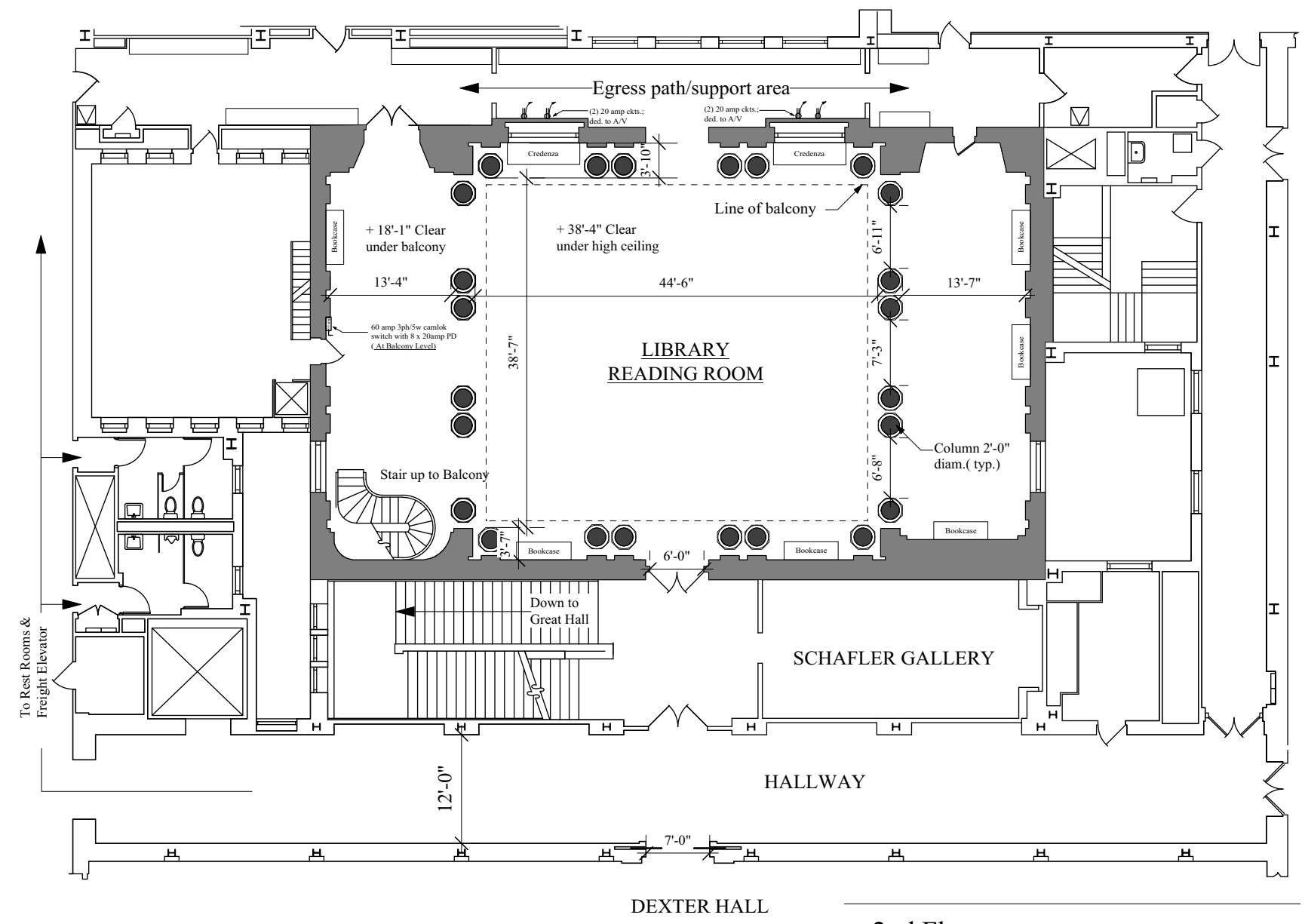

DEXTER HALL

2nd Floor

- NOTES:
1. AVAILABLE SQUARE FOOTAGE AND CAPACITIES SUBJECT TO CHANGE DEPENDING ON CURRENT EXHIBITS.
  2. ALL EVENT FURNISHINGS AND EQUIPMENT MUST BE SELF SUPPORTING.
  3. ANY CRITICAL DIMENSION OR CONDITION SHOULD BE VERIFIED IN FIELD PRIOR TO INSTALLATION.
  4. ALL MATERIALS, EQUIPMENT, AND CONFIGURATIONS TO COMPLY WITH NYC FIRE CODE
  5. SEE PARTIAL PLANS FOR INDIVIDUAL GALLERY DIMENSIONS/CAPACITIES
  6. ALL LOADING /VENDOR ENTRY AT FREIGHT ENTRANCE:
- 5 WEST 76TH ST  
 ELEVATOR CAB DIM.S: 114" W X 101" D X 108" H  
 ELEVATOR DOOR DIM.S 72" W X 103" H

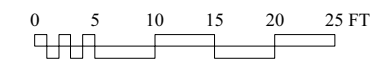

Event:	
Venue: NYHS - Patricia D. Klingenstein Library	
VENUE SPECIFICATIONS	
GROUNDPLAN	
Date: 03/08/17	Scale: 1/16" = 1'0"
<b>Production &amp; Performance Facility Consulting</b> 121 Gates Ave. Brooklyn, NY 11238 tel: 718.789.8169 fax: 718.789.1023 cdbuckley@ppfconsulting.net	
<b>201L</b>	
Db: <b>cb</b>	